

WESTORIA

816 SAGEWOOD CT., GOSHEN, IN

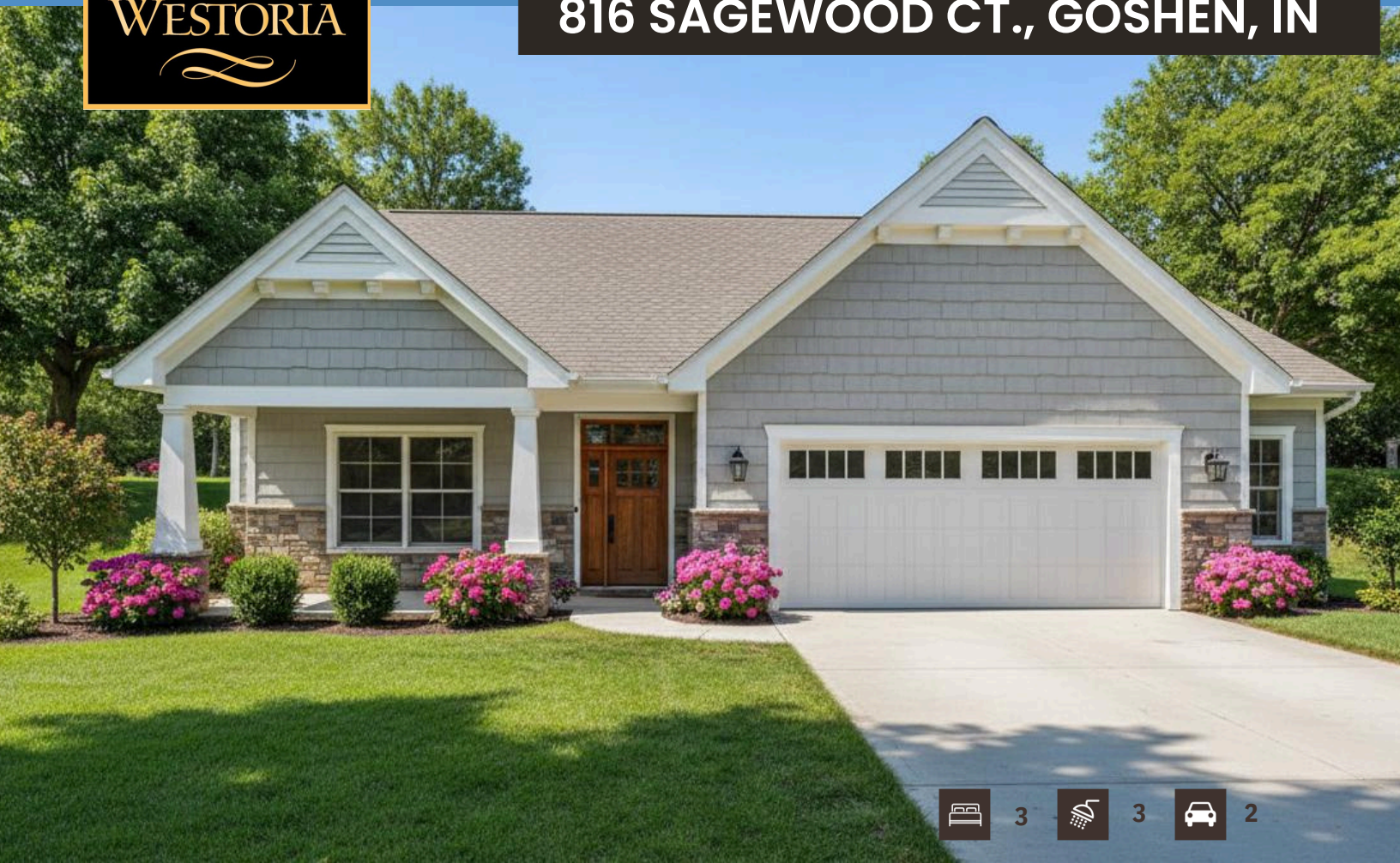

## CUSTOM MAYFIELD FEATURES

- Zero clearance entry
- Andersen windows
- Therma-tru front door
- 9ft Ceilings throughout
- Finished basement
- Walk-In Pantry
- Quartz Countertops
- Vinyl Shakes with stone accent exterior
- Maintenance free lawn and landscaping
- Covered Patio
- Ceramic shower in Primary Bath

HOME PRICE: FINISHED	\$477,550.00
BASEMENT:	\$42,450.00
LOT 41 PRICE:	\$59,900.00
LLANDSCAPE & IRRIGATION:	\$15,000.00
TOTAL HOMEPRICE:	\$594,900.00



## CONTACT US

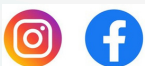

 SCHROCKHOMES.COM

 574-534-2706

 2523 MESSICK DRIVE | GOSHEN, IN



**1ST FLOOR**

1st Floor: 1700 SQ. FT.  
 Basement: 762 SQ. FT.  
 Total: 2462 SQ. FT.

Garage 616 SQ. FT.

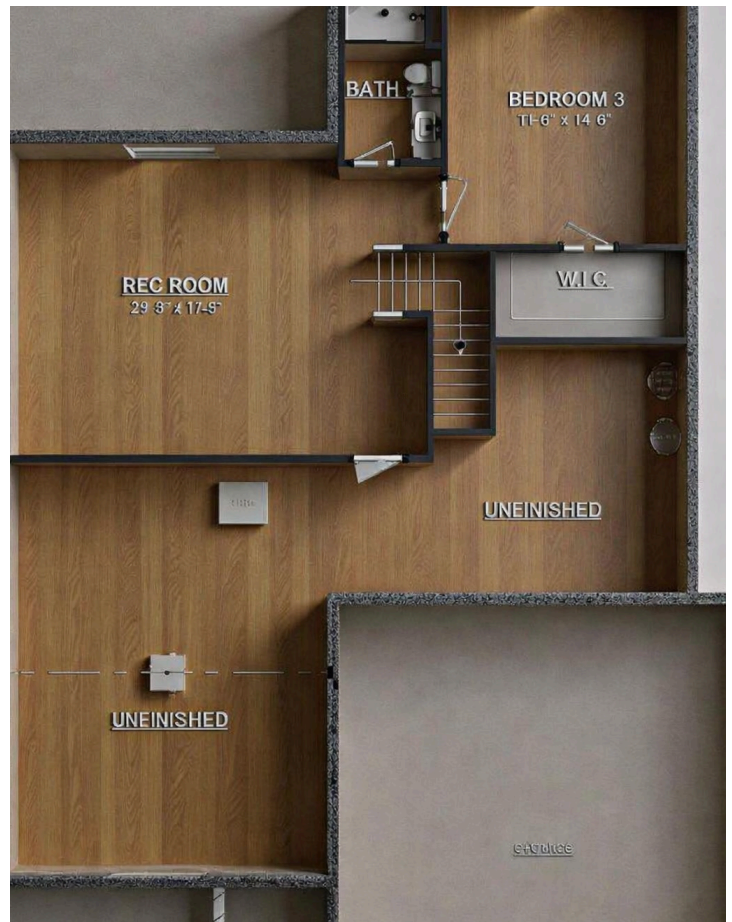

**BASEMENT**



SCHROCKHOMES.COM



574-534-2706



2523 MESSICK DRIVE | GOSHEN, IN